

Características:

Luminárias (Ex d – à prova de explosão / Ex tb à prova de poeiras) para uso em áreas classificadas Zona 1, 2, 21 ou 22, corpo, grade e acessórios em alumínio injetado de alta resistência mecânica e a corrosão, vidro borosilicato acabamento em pintura eletrostática texturizada na cor cinza claro Munsell N6.5, grau de proteção IP66, conjunto fornecido com ponto para aterramento externo. Entradas roscadas 3/4" NPT (N) ou sob encomenda BSP (B).

Conjuntos para lâmpadas conforme tabelas.

As luminárias FORTLIGHT não necessitam de unidades seladoras ou outros acessórios, já que, são fornecidas com prensa-cabo Ex integrado ao corpo.

Aplicação:

Áreas industriais, indústrias com áreas classificadas com gases ou poeiras, indústrias químicas, de processo, depósitos de produtos inflamáveis, plataformas, refinarias, indústrias farmacêuticas, silos, indústria alimentícia, etc...

- Zona 1 ou 2 grupo de gases IIA; IIB ou IIC
- Zona 21 ou 22 grupo de poeiras IIIA; IIIB ou IIIC
- Grau de proteção IP66
- Nível de segurança Gb e Db

Normas:

- ABNT NBR IEC 60079-0
- ABNT NBR IEC 60079-1
- ABNT NBR IEC 60079-31
- ABNT NBR IEC 60529

Marcação:

- Ex d IIC T* Gb IP66
- Ex tb IIIC T*°C Db IP66



1. Grade de proteção
2. Globo de vidro borosilicato
3. Anel de fixação
4. Porta-lâmpda
5. Prensa-cabo Ex
6. Corpo
7. Entradas roscadas 3/4"

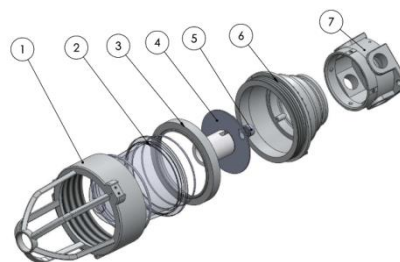

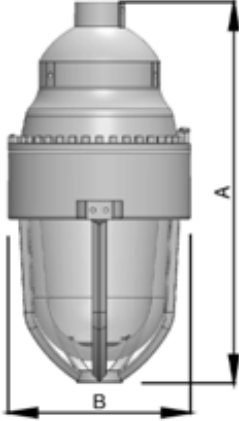
Desenho	Código	Lâmpada	Potência W	Porta-lâmpada	Class. Temp.	Dimensões mm								
						A	B	ØJ						
	FLW 10/1-INC60	Incandescent e	60	E-27	T5/95°C	310	155	¾"						
	FLW 10/1-INC100		100		T5/95°C									
	FLW 10/1-INC150		150		T5/95°C									
	FLW 10/2-INC200		200		T3/195°C				440	220				
	FLW 10/1-MIS160	Mista	160	E-40	T5/95°C	310	155							
	FLW 10/2-MIS250		250		T3/195°C				440	220				
	FLW 10/3-MIS250		250		T3/195°C									
	FLW 10/3-MIS500	500	T3/195°C											
	FLW 10/1-FC12	FC	12	E-27	T5/95°C	310	155							
	FLW 10/1-FC15		15		T5/95°C									
	FLW 10/1-FC23	FC-3U	23		T5/95°C									
	FLW 10/1-FC25		25		T5/95°C									
	FLW 10/2-FC32	FC	32		T3/195°C	440	220							
	FLW 10/1-FC-42-4P		42		GX24q-4	T5/95°C	310	155						
	FLW 10/2-FC45	FC	45	E-27	T3/195°C	440	220							
	FLW 10/2-FC65		65		T3/195°C									
	FLW 10/1-LED12		LED		12				E-27	T5/95°C	310	155		
	FLW 10/2-LED18	18		T3/195°C	440	220								
	FLW 10/3-LED40	40		E-40	T3/195°C									
	FLW 10/1-LED M8W	8					265	220						
	FLW 10/2-LED M6W	6												
	FLW 10/2-LED M9W	9												
	FLW 10/2-LED M24W	24												
	FLW 10/2-LED M36W	36												
FLW 10/2-LED M54W	54													
FLW 15/1-INC60	Incandescent e	60								E-27	T5/95°C	300	155	¾"
FLW 15/1-INC100		100									T5/95°C			
FLW 15/1-INC150		150									T5/95°C			
FLW 15/2-INC200		200	T3/195°C								500			
FLW 15/1-MIS160	Mista	160	E-40							T5/95°C	300	155		
FLW 15/2-MIS250		250								T3/195°C				500
FLW 15/3-MIS250		250		T3/195°C										
FLW 15/3-MIS500	500	T3/195°C												
FLW 15/1-FC12	FC	12	E-27	T5/95°C	300	155								
FLW 15/1-FC15		15		T5/95°C										
FLW 15/1-FC23	FC-3U	23		T5/95°C										
FLW 15/1-FC25		25		T5/95°C										
FLW 15/2-FC32	FC	32		T3/195°C	500	220								
FLW 15/1-FC-42-4P		42		GX24q-4	T5/95°C	300	155							
FLW 15/2-FC45	FC	45	E-27	T3/195°C	500	220								
FLW 15/2-FC65		65		T3/195°C										
FLW 15/1-LED12		LED		12				E-27	T5/95°C	300	155			
FLW 15/2-LED18	18		T3/195°C	500	220									
FLW 15/3-LED40	40		E-40	T3/195°C										
FLW 15/1-LED M8W	8					255	220							
FLW 15/2-LED M6W	6													
FLW 15/2-LED M9W	9													
FLW 15/2-LED M24W	24													
FLW 15/2-LED M36W	36													
FLW 15/2-LED M54W	54													

Desenho	Código	Lâmpada	Potência W	Porta-lâmpada	Class. Temp.	Dimensões mm								
						A	B	ØJ						
	FLW 16/1-INC60	Incandescent e	60	E-27	T5/95°C	360	430	¾"						
	FLW 16/1-INC100		100		T5/95°C									
	FLW 16/1-INC150		150		T5/95°C									
	FLW 16/2-INC200	200	Mista	250	E-40	T3/195°C	500	590						
	FLW 16/1-MIS160	160				T5/95°C								
	FLW 16/2-MIS250	250				T3/195°C								
	FLW 16/3-MIS250	250	FC	12	E-27	T5/95°C	360	430						
	FLW 16/1-FC15	15				T5/95°C								
	FLW 16/1-FC23	23				T5/95°C								
	FLW 16/1-FC25	25	FC-3U	25		T5/95°C								
	FLW 16/2-FC32	32				T3/195°C								
	FLW 16/1-FC-42-4P	42	FC	42	GX24q-4	T5/95°C	360	430						
	FLW 16/2-FC45	45				T3/195°C								
	FLW 16/2-FC65	65	LED	12	E-27	T3/195°C	500	590						
	FLW 16/1-LED12	12				T5/95°C								
	FLW 16/2-LED18	18				T3/195°C								
	FLW 16/3-LED40	40	LED	8	E-40	T3/195°C	360	400						
	FLW 16/1-LED M8W	8				T5/95°C								
	FLW 16/2-LED M6W	6	LED	6			330	470						
	FLW 16/2-LED M9W	9												
FLW 16/2-LED M24W	24													
FLW 16/2-LED M36W	36													
FLW 16/2-LED M54W	54													
FLW 17/1-INC60	Incandescent e	60								E-27	T5/95°C	360	350	¾"
FLW 17/1-INC100		100									T5/95°C			
FLW 17/1-INC150		150	T5/95°C											
FLW 17/2-INC200	200	Mista	250	E-40	T3/195°C	365	500							
FLW 17/1-MIS160	160				T5/95°C									
FLW 17/2-MIS250	250				T3/195°C									
FLW 17/3-MIS250	250	FC	12	E-27	T3/195°C	360	350							
FLW 17/3-MIS500	500				T3/195°C									
FLW 17/1-FC12	12				T5/95°C									
FLW 17/1-FC15	15	FC-3U	23		T5/95°C									
FLW 17/1-FC23	23				T5/95°C									
FLW 17/1-FC25	25	FC	25		T5/95°C									
FLW 17/2-FC32	32				T5/95°C									
FLW 17/1-FC-42-4P	42	FC	42	GX24q-4	T5/95°C	360	350							
FLW 17/2-FC45	45				T3/195°C									
FLW 17/2-FC65	65	LED	65	E-27	T3/195°C	365	500							
FLW 17/1-LED12	12				T5/95°C									
FLW 17/2-LED18	18				T5/95°C									
FLW 17/3-LED40	40	LED	40	E-40	T3/195°C	360	350							
FLW 17/1-LED M8W	8				T5/95°C									
FLW 17/2-LED M6W	6	LED	6			305	370							
FLW 17/2-LED M9W	9													
FLW 17/2-LED M24W	24													
FLW 17/2-LED M36W	36													
FLW 17/2-LED M54W	54													

Deenho	Código	Lâmpada	Potência W	Porta-lâmpada	Class. Temp.	Dimensões mm			
						A	B	ØJ	
	FLW 16/1P-INC60	Incandescent e	60	E-27	T5/95°C	270	450	1.1/2"	
	FLW 16/1P-INC100		100		T5/95°C				
	FLW 16/1P-INC150		150		T5/95°C				
	FLW 16/2P-INC200			200		T3/195°C	395	530	
	FLW 16/1P-MIS160	Mista		160		T5/95°C	270	450	
	FLW 16/2P-MIS250			250		T3/195°C	395	530	
	FLW 16/3P-MIS250			250	E-40	T3/195°C			
	FLW 16/3P-MIS500		500	T3/195°C					
	FLW 16/1P-FC12	FC		12	E-27	T5/95°C	270	450	
	FLW 16/1P-FC15			15		T5/95°C			
	FLW 16/1P-FC23	FC-3U		23		T5/95°C			
	FLW 16/1P-FC25			25		T5/95°C			
	FLW 16/2P-FC32	FC		32		T3/195°C	395	530	
	FLW 16/1P-FC-42-4P			42	GX24q-4	T5/95°C	270	450	
	FLW 16/2P-FC45			45	E-27	T3/195°C	395	530	
	FLW 16/2P-FC65			65		T3/195°C			
	FLW 16/1P-LED12	LED		12		T5/95°C	270	450	
	FLW 16/2P-LED18			18		T3/195°C	395	530	
	FLW 16/3P-LED40			40	E-40	T3/195°C			
	FLW 16/1-LED M8W			8					
FLW 16/2-LED M6W			6			275	485		
FLW 16/2-LED M9W			9						
FLW 16/2-LED M24W			24						
FLW 16/2-LED M36W			36						
FLW 16/2-LED M54W			54						
	FLW 17/1P-INC60		Incandescent e	60	E-27	T5/95°C	370	302	1.1/2"
	FLW 17/1P-INC100	100		T5/95°C					
	FLW 17/1P-INC150	150		T5/95°C					
	FLW 17/2P-INC200			200		T3/195°C	435	400	
	FLW 17/1P-MIS160	Mista		160		T5/95°C	370	302	
	FLW 17/2P-MIS250			250		T3/195°C	435	400	
	FLW 17/3P-MIS250			250	E-40	T3/195°C			
	FLW 17/3P-MIS500		500	T3/195°C					
	FLW 17/1P-FC12	FC		12	E-27	T5/95°C	370	302	
	FLW 17/1P-FC15			15		T5/95°C			
	FLW 17/1P-FC23	FC-3U		23		T5/95°C			
	FLW 17/1P-FC25			25		T5/95°C			
	FLW 17/2P-FC32	FC		32		T5/95°C	435	400	
	FLW 17/1P-FC-42-4P			42	GX24q-4	T5/95°C	370	302	
	FLW 17/2P-FC45			45	E-27	T3/195°C	435	400	
	FLW 17/2P-FC65			65		T3/195°C			
	FLW 17/1P-LED12	LED		12		T5/95°C	370	302	
	FLW 17/2P-LED18			18		T5/95°C	435	400	
	FLW 17/3P-LED40			40	E-40	T3/195°C			
	FLW 17/1P-LED M8W			8					
FLW 17/2P-LED M6W			6			260	400		
FLW 17/2P-LED M9W			9						
FLW 17/2P-LED M24W			24						
FLW 17/2P-LED M36W			36						
FLW 17/2P-LED M54W			54						